



---

DEEP FREEZER

**HDF-140A-SEA**  
**HDF-300A-SEA**  
**HDF-400A-SEA**

# INSTRUCTION MANUAL

---

**HOSHIZAKI CORPORATION**

3-16 Minamiyakata, Sakae-cho, Toyoake, Aichi 470-1194 Japan

L1V112111 (061424)

---

IMPORTANT SAFETY INFORMATION .....	1
I. INSTALLATION INSTRUCTIONS .....	3
1. CONSTRUCTION .....	3
2. ACCESSORIES .....	3
3. UNPACKING .....	4
4. LOCATION .....	4
5. INSTALLATION .....	5
6. ELECTRICAL CONNECTIONS .....	6
7. TRIAL RUN .....	6
II. OPERATING INSTRUCTIONS .....	7
1. OPERATION .....	7
2. LOCKING/UNLOCKING UNIT .....	8
3. DOOR OPENING/CLOSING .....	8
4. ATTACHING SEPARATOR AND BASKET (ACCESSORY) .....	8
5. TEMPERATURE SETTING .....	9
6. STORING ITEMS .....	10
7. SHUT DOWN .....	10
8. PREPARING FREEZER FOR LONG STORAGE .....	10
III. MAINTENANCE .....	11
1. MAINTENANCE .....	11
2. INSPECTION .....	13
3. BEFORE CALLING FOR SERVICE .....	14
4. RELOCATION, DISPOSAL, TRANSFER .....	15
5. WARRANTY .....	15
SPECIFICATIONS .....	16

## IMPORTANT SAFETY INFORMATION

Throughout this manual, notices appear to bring your attention to situations which could result in death, serious injury, or damage to the unit.

<b>⚠WARNING</b>	Indicates a hazardous situation which, if not avoided, could result in death or serious injury.
<b>⚠CAUTION</b>	Indicates a hazardous situation which, if not avoided, could result in minor or moderate injury.
<b>NOTICE</b>	Indicates a hazardous situation which, if not avoided, could result in damage to the unit.
<b>⚠HYGIENE</b>	Indicates important precautions for hygiene and food safety.
<b>IMPORTANT</b>	Indicates important information about the use and care of the unit.

This freezer uses HFC-free refrigerant (butane and ethylene) and HFC-free foam insulation that are non-ozone-depleting and environmentally sustainable material having very low global warming potential.

<b>⚠WARNING</b>
This freezer contains flammable refrigerant in its cooling unit; installation, handling, servicing and disposal must therefore only be carried out by authorized technicians.
The refrigerant contained in this freezer is flammable and sealed in the refrigeration system. Although the refrigerant does not leak out under normal usage, take utmost care when handling this freezer so as not to cause any damages to the system.
In the case of accidental damage to the refrigeration system causing refrigerant leak: * Do not create a source of ignition in the area. * Do not operate electrical switches or plugs in the area. * Do not use naked flame. * Immediately ventilate the area by opening doors and/or windows. * Call service engineer.

<b>IMPORTANT</b>
This booklet is an integral and essential part of the product and should be kept and preserved by the user.
Please read carefully the guidelines and warnings contained herein as they are intended to provide the installer/user with essential information for the proper installation and the continued safe use and maintenance of the product.
Please preserve this booklet for any further consultation that may be necessary.
The climatic class 4 indicates the dry bulb temperature of 30°C and relative humidity of 55 percent.

## ⚠WARNING

This is a commercial freezer, and should be destined only to be used for the purpose for which it has been expressly designed.

Any other use should be considered improper and therefore dangerous. The manufacturer will not be held liable or responsible for any damage caused by improper, incorrect and unreasonable use.

**The installation, and relocation if necessary, must be carried out by qualified personnel,** in accordance with current regulations, according to the manufacturer's instructions.

Keep ventilation openings, in the appliance enclosure or in the built-in structure, clear of obstruction.

Do not use mechanical devices or other means to accelerate the defrosting process, other than those recommended by the manufacturer.

Do not use electrical appliances inside the food storage compartment of the appliance, unless they are of the type recommended by the manufacturer.

The use of any electrical appliance involves the observance of some fundamental rules. In particular:

- \* Instances of high humidity and moisture increase the risk of electrical short circuits and potential electrical shocks. If in doubt, disconnect the freezer.
- \* Do not damage the power cord or pull it in order to disconnect the freezer from the electrical supply network.
- \* If the supply cord is damaged, it must be replaced by a replacement cord available from Hoshizaki Parts/Service Centres.
- \* Do not touch the electrical parts or operate the switches with damp hands.
- \* This appliance is not intended for use by persons (including children) with reduced physical, sensory or mental capabilities, or lack of experience and knowledge, it can however be used by children aged from 8 years and above and persons with reduced physical, sensory or mental capabilities, or lack of experience and knowledge providing they have been given supervision or instruction concerning use of the appliance by a person responsible for their safety.
- \* Children shall not play with the appliance.
- \* Cleaning and user maintenance shall not be made by children without supervision.
- \* Do not attempt to modify the freezer. Only qualified personnel may disassemble or repair the appliance.
- \* Do not store any volatile or flammable substances such as benzine, ether, adhesives and LPG, or any explosive substances such as aerosol cans with a flammable propellant in the unit.

When positioning the appliance, ensure the supply cord is not trapped or damaged.

Do not locate multiple portable socket-outlets or portable power supplies at the rear of the appliance.



The meaning of this ISO 7010 W021 symbol is:  
Warning: Risk of fire

I. INSTALLATION INSTRUCTIONS

1. CONSTRUCTION

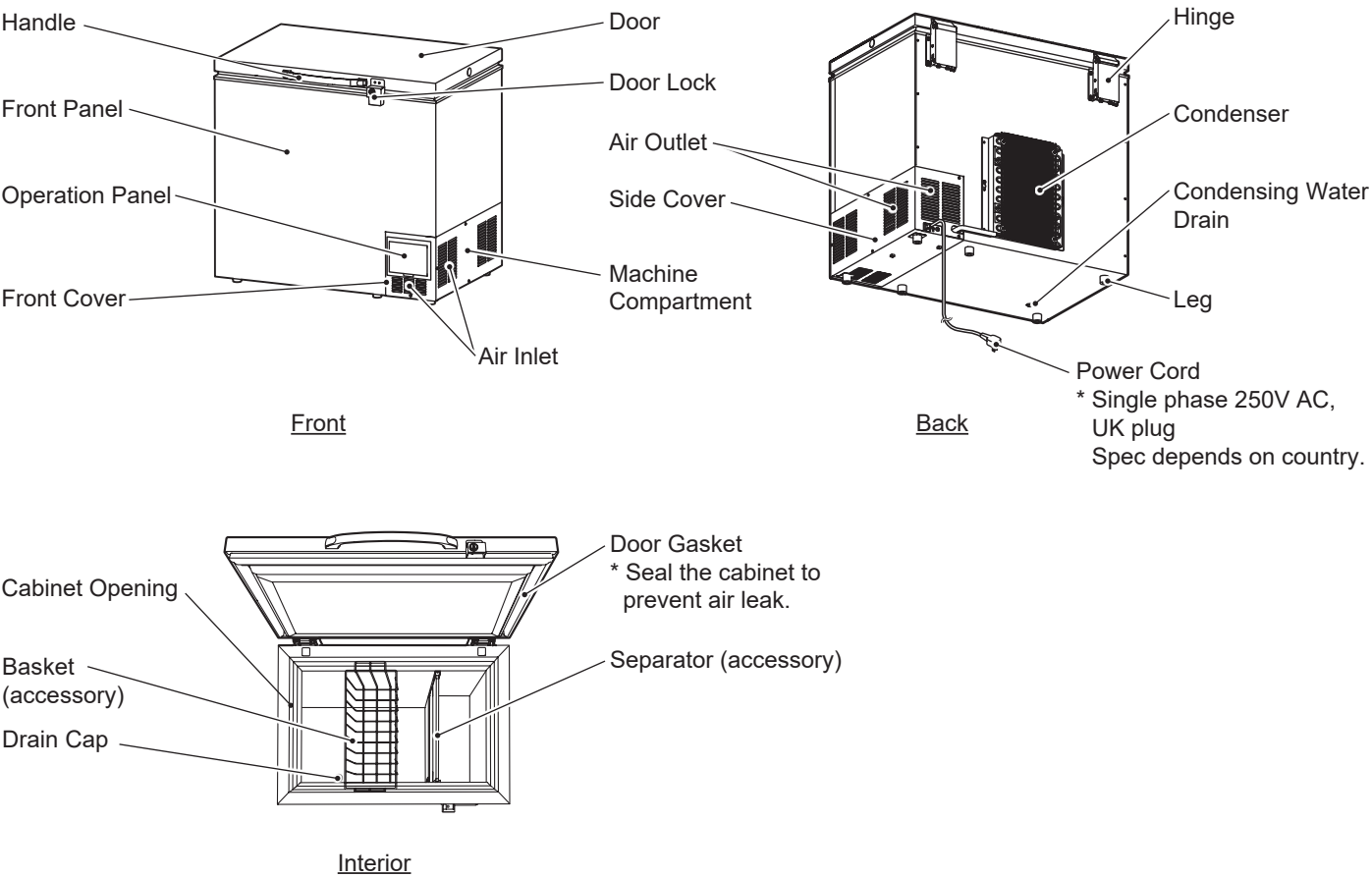

2. ACCESSORIES

	HDF-140A-SEA	HDF-300A-SEA HDF-400A-SEA
Instruction Manual	1	1
Polyethylene Scraper	1	1
Key	2	2
Separator	2	2
Basket	1	3

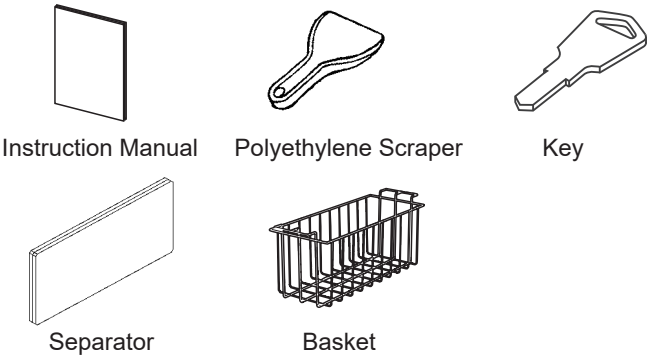

# ENGLISH

## 3. UNPACKING

### ⚠ WARNING

Unpack the unit on a firm and level foundation to avoid injury caused by overturn or fall.

When moving the unit by hand, do not hold the door, handle or front cover. It may come off and cause injury.

The plastic bags should be kept away from children or discarded to prevent possible suffocation.

### ⚠ CAUTION

When moving the unit, be careful not to turn it over.

When moving the unit, make sure that the door is closed to avoid injury or damage to the unit.

When handling the carton or the unpacked unit, work in pairs to prevent injury.

Carry the unit by holding its bottom. To prevent injury or malfunction of the unit, do not tilt the unit more than 45°.

Do not lift or manoeuvre the carton by using the shipping bands.

### NOTICE

When handling the unit, be careful not to damage exterior surfaces.

When moving the unit, do not hold the door. The door may get deformed and not close tightly, resulting in frost or poor cooling performance.

1) Check that all the exterior/interior parts are provided without damage.

2) Check the contents according to "2. ACCESSORIES".

### IMPORTANT

If any part is found damaged or missing, contact your local Hoshizaki service agent.

3) Remove the protective plastic film from the exterior. If the freezer is exposed to the sun or to heat, remove the film after the freezer cools.

Note: Do not remove the labels.

## 4. LOCATION

### ⚠ WARNING

This freezer is not intended for outdoor use. Installation in an area exposed to rain causes electric leak or shock.

Do not install the unit in an area with a high humidity or where water splashes. Degradation of insulation may cause electric leak or shock.

### ⚠ CAUTION

The location should provide a firm and level foundation for the freezer. Improper installation may result in water leaks or injury caused by overturn or fall.

### NOTICE

Normal operating ambient temperature should be within 5°C to 32°C. The unit may not operate properly outside this temperature range.

If the ambient temperature exceeds 32°C, ventilate the area using a ventilation fan or the like.

The unit should not be exposed to direct sunlight or located next to high heat producing equipment (e.g. cooking stove).

Do not use this appliance in a shaking area such as on a vehicle or ship.

To prevent malfunction of the unit, do not install the unit where exposed to corrosive gasses.

## IMPORTANT

Do not install the unit where the floor can be affected by water. In some high humidity environments, condensation may form inside the machine and drip onto the floor. Allow adequate clearance between the unit and the surrounding walls. Especially, a side-by-side or back-to-back installation (possibly with other manufacturer's unit) may cause condensation between the two units, resulting in dripping onto the floor.

Allow 10 mm extra space at the installation site to meet any installation requirements (additional spacing is also required for proper airflow and pipe connections).

The air inlet is at the lower right of the front, and the outlets are at the left side and the back of the unit.

To ensure good ventilation, do not block the machine compartment.

Allow the clearance specified below.

## NOTICE

Insufficient clearance may cause poor heat rejection, resulting in heat generation, performance reduction or failure.

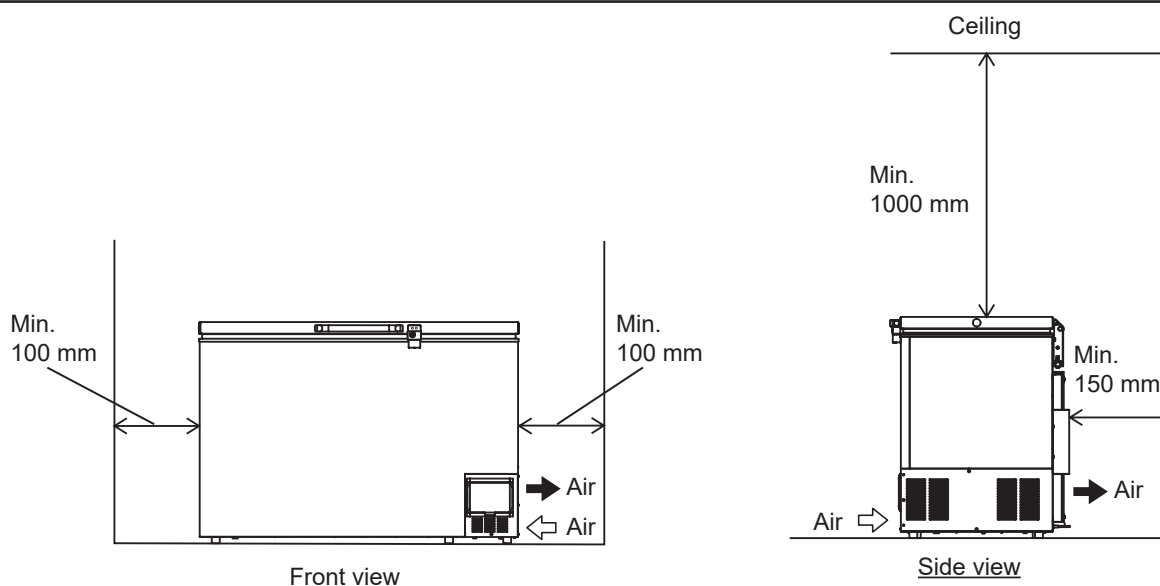

## 5. INSTALLATION

### IMPORTANT

Improper installation may result in water leaks or injury caused by overturn or fall.

Level the freezer so that the door can be closed securely.

Install the unit in an area where a firm and level foundation is provided. The unit must be leveled and well-balanced after installation.

## 6. ELECTRICAL CONNECTIONS

### ⚠ WARNING

#### THIS APPLIANCE MUST BE EARTHED

This freezer requires an earth that meets the national and local electrical code requirements.

Disconnect the main power supply before making any electrical connections to prevent possible electric shock. Attach a sign to warn against turning on the power supply during the electrical work.

Do not damage the power cord. It should not be additionally processed, jerked, bundled, weighed down or caught in. It could cause electric shock or fire.

The connection must be made to a separate power supply circuit (with overload and short circuit protections) in accordance with this instruction manual. Improper connections may cause electric shock or fire.

This unit must have a separate power supply. Branching off the power cord, using an extension cord, or sharing a single power supply with other appliances may result in electric shock, heat generation, fire or malfunction of the unit.

Securely connect the power plug to the main power supply. Improper connections may cause electric shock or fire.

### ⚠ CAUTION

The maximum allowable voltage variation should not exceed  $\pm 6$  percent of the rated voltage. Operation of the unit outside of this range may cause smoking, ignition, damage to the unit or reduction of the performance.

### IMPORTANT

This freezer is provided with no earth leakage circuit breaker, but with overcurrent protection only. Install an earth leakage circuit breaker with overload protection rated at least 15 A on the main power supply.

#### [a] FUSE

The main control box fuse is rated at 10 A and should only be replaced by a qualified service engineer.

#### [b] POWER SUPPLY LINE

See "SPECIFICATIONS" for the capacity of appliance.

## 7. TRIAL RUN

#### [a] PREPARATION

- 1) Wipe inside the cabinet with a soft cloth soaked in cold or warm water.
- 2) Attach the separator and basket according to "II. 4. ATTACHING SEPARATOR AND BASKET".
- 3) Check that each part is fixed in the proper position.

#### [b] TRIAL RUN

- 1) Check that a separate power supply of single phase 220 - 240V 50Hz is provided.
- 2) Check that the power cord is securely connected.
- 3) Turn on the main power supply and check that the temperature display lights up.
- 4) Check for proper operation.  
(At ambient temperature of 30°C, the inside of the cabinet must get cold enough in 5 to 6 hours after the unit is energized.)
- 5) Instruct the user on proper operation.
- 6) Hand over the instruction manual to the user.



## II. OPERATING INSTRUCTIONS

<b>⚠ WARNING</b>
Do not use combustible spray or place volatile and flammable substances near the unit. They could catch fire from a spark of a switch or the like.
Do not put anything (heavy goods or containers of water) on top of the unit including machine compartment. Falling goods may cause injury, and water spill may cause bad insulation or heat generation, resulting in electric leak or fire.
Do not splash water directly onto the unit. It may cause burn, short circuit, electric shock, corrosion or failure.
To prevent burn or injury, do not touch the condenser.
To prevent from being trapped or injured, do not get inside the cabinet.
Do not put a step stool near the unit. Children may get inside and trapped or injured.
To prevent frostbite, do not touch inside the cabinet with bare hands.
Do not put high heat producing equipment (e.g. cooking stove) onto/near the unit. Flammable gas may catch fire, or plastics may melt because of heat, resulting in fire.
To prevent burn or injury, do not put hands or legs into the air inlet/outlet.
Do not hang on the door or look into the cabinet. The door may get deformed, or overturn of the unit may cause injury.
When the door lock is used, the key must be kept by the administrator to avoid unexpected accidents caused by pranks.
In case of trouble (e.g. burning smell), disconnect the main power supply, and immediately contact your local Hoshizaki service agent.
When shutting down the unit for more than a week, turn off the power supply. Dust may collect and cause heat generation or ignition.
Before restarting the unit after a long shutdown, contact your local Hoshizaki service agent. To prevent possible electric shock, do not restart the unit by yourself.
Do not use this freezer for other than storing foods or the like. Otherwise, stored items may get deteriorated.
Do not step, put anything over 20 kg, or leave anything at all times on the top of the unit. The door may get deformed, or the unit may overturn, causing injury.
When opening/closing the door, hold the door handle only. Hands may get caught in the door.
Do not lean on or put anything on the opened door. The unit may overturn, resulting in injury.
<b>⚠ CAUTION</b>
To start/stop the unit, do not plug in/unplug the unit, or turn on/off the main power supply.
Do not put anything into the air inlet/outlet. The fan rotating rapidly may cause injury.
To prevent malfunction of the unit, do not put your hands inside the machine compartment. The fan rotating rapidly may cause injury, and hot parts inside the machine compartment may cause burn.
Always wear protective gloves when putting in/taking out stored items. The inside of the cabinet is extremely cold, and bare hands may stick to the interior, resulting in frostbite.
<b>NOTICE</b>
The plastic parts (handle, door frame or backside of door) must be away from pesticides or oil to prevent deformation or cracks.
Keep the machine compartment away from water or soy sauce to prevent rust or malfunction of the unit.
When using the door as a work table to cut food, use a cutting board. Do not use sharp tools directly on the door. Wipe off any food ingredients left on the door and gasket.
<b>IMPORTANT</b>
Keep this freezer clean. It is intended to store foods or the like.
There may be a plastic smell at the first use, but it does not cause harm.
Frost builds up in the cabinet. Excessive frost may drop on stored items or cause a cooling failure. Remove frost using the accessory polyethylene scraper.

# ENGLISH

## 1. OPERATION

- 1) Plug in the unit.
- 2) Turn on the power switch. The temperature display indicates the cabinet temperature, and the compressor fan motor starts in 5 minutes.

## 2. LOCKING/UNLOCKING UNIT

### ⚠WARNING

When the door lock is used, the key must be kept by the administrator to avoid unexpected accidents caused by pranks.

Before locking the freezer, make sure that nobody is inside.

This unit is provided with a door lock. To unlock, insert the key into the keyhole, and push and turn it counter-clockwise. To lock, turn the key clockwise.

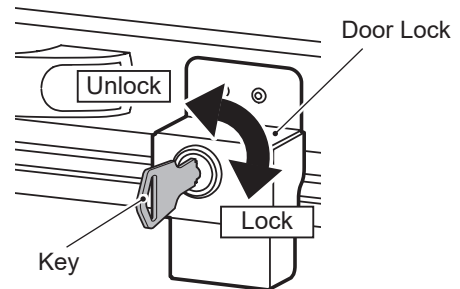

## 3. DOOR OPENING/CLOSING

### IMPORTANT

Before opening the door, make sure that nothing is put on the door.

Hold the door handle to open/close the door gently. The door may become difficult to open just after closed. Wait for a while.

Make sure that the door is closed securely. Otherwise, the cabinet temperature increases and causes deterioration of stored items.

Do not leave the door open. If the door is opened too long or often, cooling performance will be reduced.

Do not put fingers in the gap under the door.

## 4. ATTACHING SEPARATOR AND BASKET (ACCESSORY)

Attach the separators along the separator guides.  
Hook the basket in the grooves inside the cabinet.

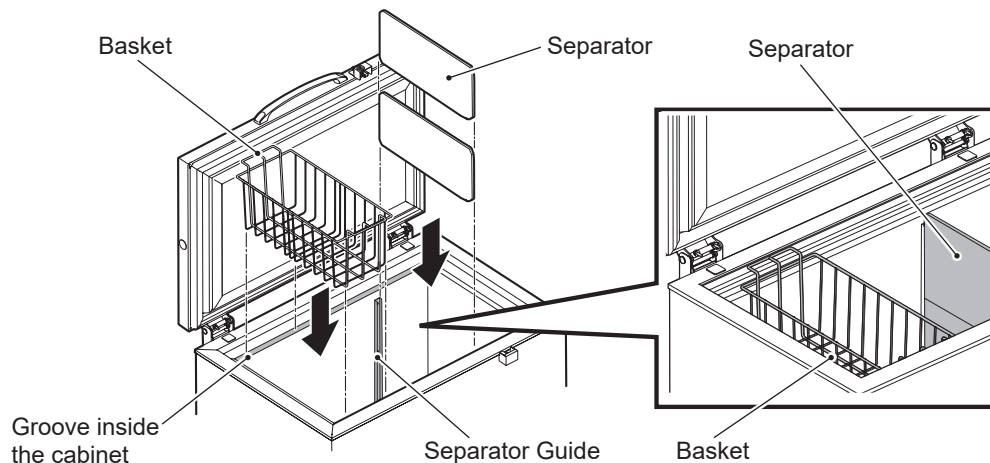

## 5. TEMPERATURE SETTING

The cabinet temperature is factory-adjusted to -60°C. If necessary, readjust the temperature using the set key on the operation panel.

IMPORTANT	
Pressing the down key will not speed up refrigeration, but will only lower the temperature setting.	
The temperature setting range given in "SPECIFICATIONS" is only the adjustable range. The displayed cabinet temperature depends on the ambient temperature and other conditions.	
The displayed cabinet temperature is adjusted to be almost equal to the temperature at the center of the cabinet with no load. But it can be different from the actual temperature depending on arrangement of stored items, frequency of door opening or measuring points.	

### Operation Panel

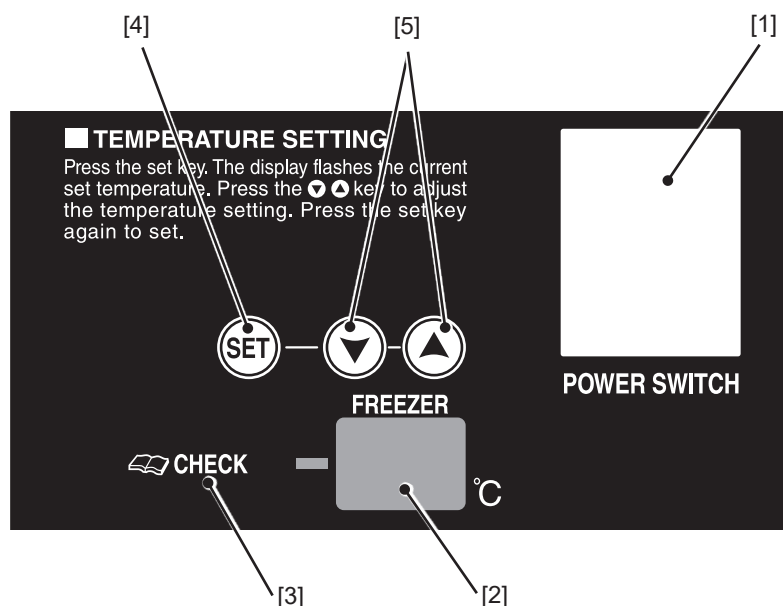

- [1] Power Switch  
Turns on/off the unit.
- [2] Temperature Display  
Indicates the cabinet temperature.  
Flashes error code when an error occurs.
- [3] Check Lamp  
Lights up when an error occurs.
- [4] Set Key  
Displays/changes the cabinet temperature.
- [5] Up/Down Key  
Increases/decreases the cabinet temperature.  
To reset the check lamp/error code indication/buzzer, use the up key.

1) Press the set key on the operation panel. The display flashes the current set temperature.

\* To go back to the current temperature indication, wait for 10 seconds or press the set key again.

2) While the set temperature is flashing, press the up/down key to adjust the temperature setting.

3) Press the set key.

\* After 10 seconds without pressing the set key, no settings will be stored, and the display goes back to the current temperature indication.

# ENGLISH

## 6. STORING ITEMS

⚠ CAUTION
Do not throw anything into the basket or load more than 10 kg in it. The basket may fall off and cause injury.
Stored items must be wrapped up in a -60°C resistant plastic film or packed in a container. Extremely cold items easily get broken when they fall off, causing a risk of injury. Also, the items may adversely affect other items or get deteriorated.
Do not put in warm or hot items. Let them cool first, or they will raise the cabinet temperature and could deteriorate other stored items in the cabinet or overload the refrigeration system.
Do not touch items in the cabinet (especially items made of metals) with damp hands. Hands may stick to the items, resulting in frostbite.
Do not store bottles or cans. They may freeze up and break, causing a risk of injury.

Energize the freezer for 5 to 6 hours and check for proper temperature before putting frozen items in the cabinet.

NOTICE
If a stored item containing acetic acid adheres to the door gasket, wipe it off. Otherwise, the door gasket may get discolored or deformed.
To prevent malfunction of the unit, do not use this unit to freeze water or a large amount of raw food.
Do not store a commercially available coolant (containing ammonium acetate or urea). Leaked contents may cause rust or malfunction of the unit.

IMPORTANT
The inside of the cabinet is cooled directly by the evaporator. Stored items are not exposed to cold air but cooled slowly by natural convection, and kept fresh for a long time. Depending on the area in the cabinet, the temperature may be too low/high.
Do not use this product to freeze foods or the like. It is designed only to store frozen items.
Store items to fit in the basket.
Do not pack the cabinet. The cabinet temperature increases and an error code may be displayed.

## 7. SHUT DOWN

Turn off the power switch and unplug the unit.

IMPORTANT
When shutting down the unit for long storage, clean the interior and door gasket.

## 8. PREPARING FREEZER FOR LONG STORAGE

⚠ WARNING
When shutting down the unit for long storage, avoid the door to be tightly closed. Children may get trapped in the cabinet.
When shutting down the unit for long storage, store the unit in a well ventilated area. In case of gas leak, refrigerant gas accumulates and causes a risk of fire.

- 1) Turn off the power switch and unplug the unit.
- 2) Carry out all the maintenance procedures stated in "III. 1. MAINTENANCE".

## III. MAINTENANCE

### ⚠ WARNING

When using a detergent, thoroughly read and understand the instructions provided to prevent potential health problems.

### ⚠ HYGIENE

Periodic cleaning and maintenance are required to prevent bacterial proliferation and food decay.

## 1. MAINTENANCE

Use an invert soap (benzalkonium chloride) for daily maintenance.

To use an invert soap (benzalkonium chloride), consult your local Hoshizaki service agency.

Dilute an invert soap (benzalkonium chloride) according to its manufacturer's instructions.

Remove dirt by using a cloth containing a neutral cleaner. After using a neutral cleaner, wipe thoroughly with a cloth containing clean water. Then use an invert soap.

### NOTICE

To prevent damage to the painted or plastic surfaces, do not use thinner, benzine, alcohol, petroleum, soap powder, polishing powder, alkaline detergent, acid, scrub brush, and especially cleanser for use on fans and cooking ranges. Also, do not use any corrosive materials or chlorine bleach (sodium hypochlorite).

When using a chemical cloth, follow the instructions for use.

Any remaining detergent will damage metal or plastic surfaces.

Do not splash cold or warm water directly onto the unit. It may cause deformation or malfunction of the unit.

### IMPORTANT

Before cleaning the interior, remove all stored items.

### [a] DOOR, HANDLE AND CABINET OPENING (DAILY)

Check that there is no water collected at the door gasket. If the gasket freezes, it may get damaged.

The door and handle get soiled easily. Clean every surface of these parts thoroughly to keep them clean.

Wipe the door, handle and cabinet opening with a clean cloth containing an invert soap. After 5 minutes, use a cloth damped with clean water to wipe off any remaining solution.

Use the accessory polyethylene scraper to remove frost from the door and cabinet opening.

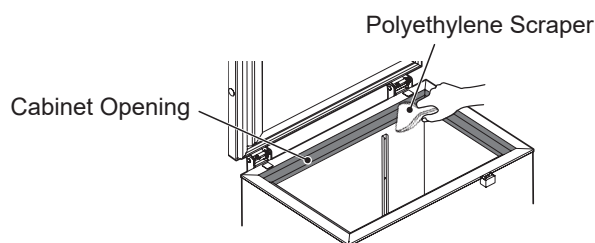

### [b] DOOR GASKET AND ITS CONTACT SURFACE (WEEKLY)

The door gasket and its contact surface get soiled easily. Clean every surface of these parts thoroughly.

Wipe the door gasket and its contact surface with a clean cloth containing an invert soap. After 5 minutes, use a cloth damped with clean water to wipe off any remaining solution. For heavy soil, remove the gasket from the door and wipe it with a cloth containing a neutral cleaner diluted with water according to its manufacturer's instructions. Wipe off any remaining solution after cleaning.

### NOTICE

To clean the door gasket and its contact surface, do not use acid or alkaline detergent, bleach or alcohol. The door gasket may get deteriorated (hardened or deformed), resulting in cold air leak.

To prevent deterioration of the gasket, do not leave vinegar or cooking oil.

Remnants of food will accelerate aging.

The door gasket is made of plastic. To prevent deformation, do not wash it with water above 40°C.

# ENGLISH

To remove the door gasket from the unit, remove its corner first.

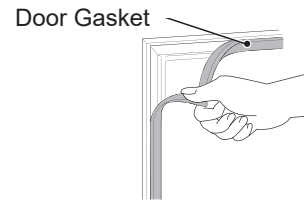

## NOTICE

To prevent damage to the gasket, do not strongly pull its corner.

### [c] EXTERIOR (WEEKLY)

The exterior collects dust, moisture or oil easily. To keep it clean, wipe every exterior surface thoroughly with a cloth containing an invert soap. After 5 minutes, use a cloth dampened with clean water to wipe off any remaining solution.

## NOTICE

The exterior is made of painted steel sheet. To prevent corrosion, keep it clean.

To prevent damage to the painted surfaces, do not use commercially available stainless steel cleaner.

Severe damage on the painted surfaces may cause corrosion.

### [d] BASKET (WEEKLY)

## ⚠ CAUTION

Attach the basket properly. Otherwise, it may fall off and cause injury.

Before cleaning the basket, remove all stored items.

Wipe the basket with a clean cloth containing an invert soap. After 5 minutes, use a cloth dampened with clean water to wipe off any remaining solution.

### [e] INTERIOR

Use the accessory polyethylene scraper to remove frost from the interior once a week.

## NOTICE

Do not use any sharp tools to remove frost. The painted surfaces may get damaged and corrode. To prevent damages to the interior, use the accessory polyethylene scraper.

Clean the interior once a year or when it is dirty.

Before cleaning the interior, open the door and wait until frost melts away.

## NOTICE

Do not splash cold or warm water directly into the cabinet. Rapid temperature change may cause deformation or failure.

Severe damage on the surfaces may cause corrosion.

- 1) Turn off the power switch and move all stored items to another freezer.
- 2) Open the door and leave it open.
- 3) When frost starts to melt, remove the drain cap to drain.
- 4) Wipe the interior with a clean cloth containing an invert soap. After 5 minutes, use a cloth dampened with clean water to wipe off any remaining solution.

### [f] SEPARATOR (ANNUALLY)

Wipe the separator with a clean cloth containing an invert soap. After 5 minutes, use a cloth dampened with clean water to wipe off any remaining solution.

## [g] FRONT COVER, SIDE COVER AND CONDENSER (ANNUALLY)

### ⚠ CAUTION

When cleaning the condenser, wear protective gloves to prevent burn or injury.

Dust and dirt buildup on the front cover, side cover or condenser may cause improper operation or reduce cooling performance. Use a brush or vacuum cleaner to clean off.

### IMPORTANT

Frequent cleaning is required in a dusty area.

Before cleaning the condenser, wait until it cools.

## 2. INSPECTION

### [a] SAFETY INSPECTION BY SERVICE PERSONNEL

Even if there are no problems with its use, a product out of warranty may have a risk of electric shock, fire, or water leak due to insulation degradation or aging of the electrical parts. Ask your local Hoshizaki service agent for the following inspections (charged):

- Dust and dirt buildup inside the unit or water leak
- Aging conditions of the unit and its components

### [b] KEYHOLE (MONTHLY)

If the key gets stuck or hard to turn, apply lubricant into the keyhole. Use keyhole or quick-drying lubricant.

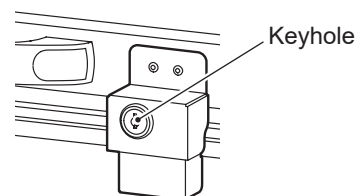

### NOTICE

If there is moisture in the keyhole, lubricant will not work properly. Wait until the keyhole dries.

Do not use lubricant oil having high viscosity or rust-proof lubricant. Those kinds of lubricant get mixed with dust and dirt, and make the key stuck in the keyhole.

### [c] POWER PLUG AND POWER CORD (ANNUALLY)

Check the power cord to see if:

- The power cord is not overheated, damaged, melted, weighed down or caught in. In case of any trouble, immediately contact your local Hoshizaki service agent.
- There is no dust collected on and around the power plug blades or electric outlet. In case dust is collected, clean off.
- The power cord is connected to a separate power supply.

# ENGLISH

## 3. BEFORE CALLING FOR SERVICE

If the freezer does not work properly, check the following table before calling for service. If the problem still exists, turn off the power switch and contact your local Hoshizaki service agent. When contacting your local Hoshizaki service agent, let them know the model name, serial number, date of installation (see warranty card) and state of the trouble.

Do not attempt to repair the unit by yourself. Only qualified personnel may repair the unit.

### [a] ERROR CODE INDICATION

Code	Error	Description
60	Cabinet temperature too high	Ambient temperature is 32°C or higher. Use a fan or air conditioner.
		Warm or hot items are stored. Let items cool before putting into the cabinet. Warm or hot items will raise the cabinet temperature and could deteriorate other stored items or overload the freezer.
		The door is left open. Close the door to prevent reduction of cooling performance.
		A large amount of frozen items are put into/taken out from the cabinet. There is no problem if the cabinet temperature goes down gradually in about 30 minutes. The error code indication will reset when the cabinet temperature reaches the set temperature. If the cabinet temperature will not go down, immediately call your local Hoshizaki service agent.
		To keep the cabinet temperature extremely low, put in/take out a small amount of items at a time.
		The condenser is not clean. Clean it.
		If not applicable to the above, the refrigerant may have leaked. Follow the instructions below. 1) Do not use naked flame or operate electrical appliances in the area. 2) Ventilate the area by opening windows. 3) Do not operate electrical switches or plugs in the area. 4) Immediately call your local Hoshizaki service agent.
40, 41	Control board error	Contact your local Hoshizaki service agent.
47, 48	Discharge pipe thermistor error	
66, 67	Cabinet thermistor error	
80, 91	Component error	

### [b] CANCELING CHECK LAMP, ERROR CODE INDICATION AND BUZZER

When the buzzer is sounding and the check lamp and error code indication are flashing, press and hold the up key on the operation panel for 3 seconds to cancel them. (Only the buzzer can be cancelled for other than 60, 66 and 67.)



## [c] NO ERROR CODE INDICATION

Problem	Possible cause
Unit fails to operate	The power cord is disconnected.
	Power failure.
	Main power supply is off.
	The fuse is tripped. Replace it.
Poor cooling performance	Ambient temperature is 32°C or higher. Use a fan or air conditioner.
	The door is opened too often.
	The cabinet temperature setting is too high.
	The cabinet is too packed with items. Allow some space between them to ensure good airflow.
	Warm or hot items are stored. Let cool items before putting into the cabinet. Warm or hot items will raise the cabinet temperature and could deteriorate other items or overload the freezer.
	The door is left open.
Condensation on exterior	The door is not closed tightly.
	Ambient humidity is too high. Wipe off condensation.
	The door is opened too often. Wipe off condensation.
Hot exterior surfaces	The anti-condensation pipe and heat releasing pipe (condenser) are mounted in the unit. They raise temperature of the unit front, side or back, but will not deteriorate stored items.
Noise	Normal operating sounds from the refrigeration system.
	The unit is installed on unsteady floor. Contact your local Hoshizaki service agent.
	The unit is installed on uneven floor.
	The back side of the unit is in contact with a wall. Allow some space between them.

## 4. RELOCATION, DISPOSAL, TRANSFER

\* In case of relocation or disposal of the product, contact your local Hoshizaki service agent.

\* When selling or transferring this product, tape this instruction manual to the exterior to provide the new owner with information on safe and proper use of the product.

## 5. WARRANTY

Hoshizaki warrants to the original owner/user that all Hoshizaki branded products shall be free of defects in material and/or workmanship for the duration of the "warranty period". The warranty shall be effective for one year from the date of installation. Hoshizaki's liability under the terms of the warranty are limited and shall exclude routine servicing, cleaning, essential maintenance and/or repairs occasioned by misuse and installations not in accordance with Hoshizaki guidelines.

Warranty repairs should be completed by an approved Hoshizaki dealer or service agency using genuine Hoshizaki components.

To obtain full details of your warranty and approved service agency, please contact your local Hoshizaki service agent, or the nearest Hoshizaki Service office:

# ENGLISH

Hoshizaki Singapore  
TEL: +65 6225 2612  
FAX: +65 6225 3219  
sales@hoshizaki.com.sg (Sales)  
serviceadmin@hoshizaki.com.sg (Technical support)

Hoshizaki Thailand  
TEL: +66 2 005 9980  
Line: @hoshizakithailand  
<https://www.facebook.com/HoshizakiThailand>

Hoshizaki Hong Kong  
TEL: +852 2866 2108  
FAX: +852 2866 2109

Hoshizaki Vietnam  
TEL: +8428 5417 3853  
sales@hoshizaki.com.vn (Sales)  
service@hoshizaki.com.vn (Technical support)

Hoshizaki Malaysia  
TEL: +60 3 8023 5823  
FAX: +60 3 8024 1823

## SPECIFICATIONS

Model	HDF-140A-SEA	HDF-300A-SEA	HDF-400A-SEA
Power Supply	1 phase 220 - 240V 50Hz Capacity: 0.91kVA (3.8A)	1 phase 220 - 240V 50Hz Capacity: 1.14kVA (4.8A)	1 phase 220 - 240V 50Hz Capacity: 1.14kVA (4.8A)
Capacity	140L	298L	385L
Temperature Setting Range	-60 to -50°C	-60 to -50°C	-60 to -50°C
Safety System	Fuse (10A)	Fuse (10A)	Fuse (10A)
Exterior	Stainless steel, painted steel	Stainless steel, painted steel	Stainless steel, painted steel
Weight	Net: 59kg (Gross: 65kg)	Net: 84kg (Gross: 93kg)	Net: 94kg (Gross: 104kg)
Dimensions	725mm(W) x 693mm(D) x 875mm(H)	1265mm(W) x 710mm(D) x 875mm(H)	1565mm(W) x 710mm(D) x 875mm(H)
Refrigerant	R600/1150, 85g	R600/1150, 140g	R600/1150, 140g
Ambient Temperature	5 to 32°C	5 to 32°C	5 to 32°C
Voltage Range	Rated voltage $\pm$ 6%	Rated voltage $\pm$ 6%	Rated voltage $\pm$ 6%